



**REPLACEMENT & RETROFIT**

# PTAC

**PACKAGED TERMINAL AIR CONDITIONER**



**ADVANCED GREEN TECHNOLOGY**





## CONTENTS

ICE AIR ExactFit™ PTAC Units	3
Product Specifications	4
Performance Specifications	5
Quick Reference Replacement Guide	6
ICE AIR ExactFit™ <b>RS16</b>	7
ICE AIR ExactFit™ <b>RS41</b>	7
ICE AIR ExactFit™ <b>RSCM A/B/C</b>	8
ICE AIR ExactFit™ <b>RSCT</b>	8
ICE AIR ExactFit™ <b>RSCT-JK</b>	9
ICE AIR ExactFit™ <b>RSCT-ZS</b>	9
ICE AIR ExactFit™ <b>RSEA</b>	10
ICE AIR ExactFit™ <b>RSF</b>	10
ICE AIR ExactFit™ <b>RSIW</b>	11
ICE AIR ExactFit™ <b>RSK</b>	11
ICE AIR ExactFit™ <b>RSK/K</b>	12
ICE AIR ExactFit™ <b>RSMK</b>	12
ICE AIR ExactFit™ <b>RSNH</b>	13
ICE AIR ExactFit™ <b>RSZ</b>	13
ICE AIR ExactFit™ <b>WL</b>	14
Made2Measure	14
Accessories	15
ACCUZONE® Advanced Controls	16
Advanced Features	17
Other Products	18
<b>NEW!</b> Hybrid Water-Cooled A/C	19
<b>NEW!</b> Single Package A/C and Heat Pump	19



## EXACTFIT™

### ICE AIR ExactFit™ PTAC Units

ExactFit™ Packaged Terminal Air Conditioners (PTACs) are manufactured exclusively by ICE AIR to provide an “Exact Fit” replacement for your original thru-wall cooling and heating equipment.

ICE AIR manufactures a complete line of ExactFit PTACs and Heat Pumps (PTHPs) designed to fit into existing OEM wall sleeves and ensure a simple slide-in retrofit for your existing units. We have 40 years of experience in providing superior cooling and heating products, guaranteeing you a highly efficient, top quality replacement unit that will provide many years of quiet, reliable comfort conditioning.

Our units are manufactured to top commercial-grade standards and include heavy-duty galvanized and powder-coated sheet metal casings with powder-coated bases and drain pans. They have UL listed components and full-line safety certification by ETL Laboratories for the U.S. and Canada to ensure your safety and code compliance. ICE AIR is a member of USGBC and is committed to protecting our environment and providing energy savings to our customers. We use R-410A non-ozone depleting refrigerant throughout all of our product lines.

Over the years, we have provided hundreds of thousands of PTAC units, ensuring that you can specify, purchase and install our ExactFit PTACs with confidence in multifamily residential, hotel, motel, dormitory, nursing home, health care and similar facilities.

### ICE AIR ExactFit™ RS Series PTAC units

- Simple, slide-in replacement chassis
- Replace all major OEM equipment
- “Quick Ship” programs from stock for most units
- Exceed ASHRAE 90.1 standards
- ETL Listed and tested to ARI standards
- Available with electric heat, heat pump or hydronic heat interface options
- Powder-coated galvanized steel drain pan for corrosion protection
- No building condensate drain lines required
- Interfaces with new or existing Building Management Systems
- High efficiency compressors and motors
- Dual motors for lower winter heating costs and longer use
- Standard four-position mode switch (six-position switches for both RSK & RSCT are also available)
- Optional unit- or wall-mounted digital programmable controls
- Permanent, washable aluminum mesh filter
- Heat pump option available for energy savings

Call **ICE AIR at 877-ICE-AIR-1 (877-423-2471)** or visit us online at **[www.ice-air.com](http://www.ice-air.com)** to learn more about ExactFit PTACs and all ICE AIR replacement and retrofit products and services.

## TYPICAL PRODUCT SPECIFICATIONS

### ICE AIR ExactFit™ REPLACEMENT PTAC - Packaged Terminal Air Conditioners

**EQUIPMENT:** Provide "RS--" Series Packaged Terminal Air Conditioners (PTAC), as manufactured by ICE AIR, LLC. Units to be an "exact fit" replacement for original equipment, and unit series indicator to indicate proper physical configuration for the required replacement series.

**COMPONENTS:** Air conditioner to consist of cooling chassis with integral electric heat, heat pump and/or hydronic heat wiring. (Provide optional wall sleeve, exterior louver, heating coil assembly and room enclosure). Units to operate on either 115 volt, 208/230 volt, or 265/277 volt, single phase, 60 hertz circuits or at 220/240 volt, single phase, 50 hertz circuits, depending on original building wiring.

**CHASSIS:** Cooling chassis to be a self-contained, slide-in assembly consisting of a sealed refrigerant system, evaporator and condenser sections with two separate PSC motors (single motor units are not acceptable), unit-mounted controls (optional remote wall mount) and line cord (junction box for 265/277 volt applications). Provide a permanent, washable aluminum mesh filter with each unit.

**(OPTIONAL) ELECTRIC HEATING ELEMENT:** Electric heaters to include Positive Temperature Co-efficient (PTC) heating elements with self-limiting temperature features. PTC self-regulating heaters ensure safety and provide dynamic energy efficiency and reliability.

**REFRIGERATION SYSTEM:** Sealed refrigerant system to consist of high efficiency rotary compressor, copper tube/aluminum fin evaporator and condenser coils, refrigeration metering device and interconnecting tubing. System to be factory charged and sealed and capable of operating in the cooling mode to an outdoor ambient temperature of 35°F.

**EVAPORATOR SECTION:** Evaporator motor and blower wheels to be mounted on a slide-out, easily removable motor board. Blower wheels to be metal double-inlet, forward curved centrifugal type, directly driven by a three-speed PSC motor with built-in automatic reset overload protector. Evaporator section to contain an integral galvanized steel condensate pan lined with an additional molded and powder-coated steel drain pan, draining into two separate minimum 3/4" i.d. PVC drain hoses.

**CONDENSER SECTION:** Condenser section to contain a separate PSC motor and metal propeller fan with an integral slinger ring. Condenser motor to cycle with compressor and to run during the cooling cycle only.

**CONDENSATE DISPOSAL:** Condensate to drain from the indoor evaporator pan into a powder-coated exterior galvanized steel condenser base pan (uncoated base pans are not acceptable) through two 3/4" i.d. PVC drain hoses. Condensate disposal to be accomplished by the entrainment of condensate water particles in the condenser air stream and evaporation of the water particles on the hot condenser coil. No building condensate drain lines are to be required.

**CHASSIS SHEET METAL:** Chassis sheet metal parts to be manufactured entirely of 18-gauge and 20-gauge galvanized steel. Chassis to be manufactured with proper sealing angles, channels or sheet metal configuration to ensure proper mating with the wall sleeve interior flanges and to create a positive weather seal using crushable pressure-sensitive foam tape, thereby preventing air and water infiltration.

**UNIT CONTROLS:** Standard unit controls to include a four-position mode switch (Off - Heat - Hi Cool - Low Cool) and unit-mounted rotary control thermostat. (Provide optional low-temperature control to activate motorized heating control valve below 45°F interior room temperature). Six-position switches for both RSK & RSCT are also available.

**(OPTIONAL) DIGITAL TOUCHPAD:** Unit controls to include digital touchpad controls with integral mode, fan speed & mode, adjustable temperature settings, 5/2 or 7-day programmable settings and digital read-out.

**(OPTIONAL) REMOTE THERMOSTAT:** Unit controls to consist of optional wall-mounted thermostat and chassis-mounted control board.

**WARRANTY AND CODE COMPLIANCE:** Unit to be guaranteed free of defects in material and workmanship for one year from date of delivery. Provide (OPTIONAL) additional 2nd through 5th year compressor parts warranty. Units to be ETL listed for safety in the United States and Canada, to have New York City MEA and BEC approvals, to be in compliance with all local, state and federal energy efficiency and building codes, and to be tested in accordance with current ARI standards.

## TYPICAL PERFORMANCE SPECIFICATIONS

### ICE AIR ExactFit™ PTAC Performance Specifications

	MODEL NUMBER									
	5RS__07	5RS__09	5RS__13	8RS__09	8RS__13	8RS__16	8RS__18	7RS__09	7RS__13	7RS__18
Nominal Cooling Capacity (1)	8,100	9,500	12,750	9,700	12,700	14,400	16,200	9,250	12,500	16,200
Cooling EER	11.0	10.5	10.0	10.3	10.0	9.3	9.3	10.5	10.0	9.3
Heating Capacity HW (2)	16,500	16,500	16,500	16,500	16,500	19,400	19,400	16,500	16,500	19,400
Heating Capacity STM (3)	18,700	18,700	18,700	18,700	18,700	20,000	20,000	18,700	18,700	20,000
Electric Heat Capacity (KW)	1.5	1.5	1.5	1.5	3.5/4.3	3.5/4.3	3.5/4.3	1.5	3.5/4.3	3.5/4.3
Voltage	115	115	115	208	208	208	208	277	277	277
Amperage	6.5	7.9	11.0	6.3	6.1	7.4	8.4	3.4	4.8	6.6
Watts	740	900	1,270	940	1,270	1,550	1,750	900	1,270	1,750
CFM Air Hi Cool	370	370	370	370	430	430	480	370	430	480
CFM Air Lo Cool	260	260	260	260	330	330	330	260	330	330
CFM Outside Air	60	60	60	60	60	60	60	60	60	60
CFM Extra Outside Air	110	110	110	110	110	110	110	110	110	110
Weight - Net/Ship	113/129	117/133	124/138	113/129	124/138	132/148	141/157	117/133	124/138	141/157

**Notes:**

1. Btu/h @ 80°F DB/67°F WB Indoors/95°F DB Outdoors
2. Btu/h @ 200°F E.W.T./65°F E.A.T./2 GPM Flow Rate
3. Btu/h @ 2 P.S.I.G. Steam/65°F E.A.T.
4. For heat pump performance, contact ICE AIR directly



### ADVANCED GREEN TECHNOLOGIES



ICE AIR's PTACs set the standard for environmentally friendly HVAC equipment. We use R-410A non-ozone-depleting refrigerant throughout all of our product lines. And our advanced digital controls achieve optimum user comfort while saving energy, ensuring that our products safeguard the environment, inside the building and out.



### INDUSTRY BEST SOUND LEVELS



ICE AIR's commercial grade units utilize the highest quality materials and manufacturing practices in order to provide years of whisper quiet and cost-effective operation. Advanced compressor isolation technology, top grade thermal and sound insulation and right-sized air handling components provide low sound levels while achieving optimum comfort.

### HIGH LEVELS OF ENERGY EFFICIENCY



ICE AIR manufactures the highest-efficiency PTACs on the market, with EERs to 12.0. As a member of the USGBC (Green Building Council), we are committed to delivering highly efficient comfort conditioning equipment that provides multiple benefits to our customers – including lower operating costs, enhanced LEED points and a healthy environment.



## REPLACEMENT GUIDE

### ICE AIR ExactFit™ REPLACEMENT PTAC Packaged Terminal Air Conditioners



ORIGINAL MANUFACTURER	MODEL/SERIES	
American Air Filter (AAF)	Type 25 Type 16	RS41 RS16
American Standard	Type 41 Type 45	RS41 RS16
ClimateMaster	700 AD 702,703,704	RSCM/B* or C* RSCM/A
Cool Heat	RM	RSZ
Embassy	Weather Twin	RSZ
Fedders	Maxizone	RSF
Friedrich	700 AD 702,703,704	RSCM/B* or C* RSCM/A
Ice-Cap	RSK RSCT RSCT-ZS	RSK RSCT RSCT-ZS
Islandaire	AD CM ED JK KF NE MX RK RM RT WL 16 41	RSCM/B* or C* RSCM/A RSEA RSCT-JK RSMK/RSK/K RSNH RSF RSK RSZ RSCT WL RS16 RS41
W, Wenig	WL "Coffin" IW "Step Up"	WL RSIW
McQuay	EA, ES, RS N, NH, PDNS PNES, ENR K, EK, RK	RSEA RSNH RS16 RSMK
Remington	EA, ES, RS K, EK	RSEA RSMK
RetroAire	RC15 RC40 RC/RH10 RC/RH20 RC/RH22 RC/RH35 RC/RH60 RC/RH90	RS41 RSF RS16 RSZ,RSCM/A RSK RSEA RSMK, RSK/K RSCM/B* OR C*
Singer	EA, ES, RS N, NH K, EK TYPE 16	RSEA RSNH RSMK RS16
SlantFin	JK	RSCT-JK
TPI	RaMatic	RSZ
Trane	PTEC/PTHC	RSHM
Weil-McLain	700 AD	RSCM/B* OR C*
ZoneAire	RM, SC	RSZ

\*Control box configuration must be specified

## ICE AIR RS16

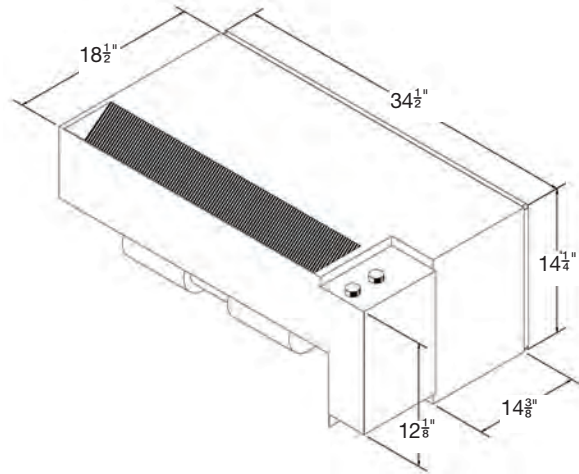

ICE AIR MODEL	MANUFACTURER	SERIES
RS16	AMERICAN AIR FILTER (AAF)	TYPE 16
	AMERICAN STANDARD	TYPE 45
	McQUAY	TYPE 16
	SINGER	TYPE 16
	ISLANDAIRE	16
	RETROAIRE	RC/RH10

## ICE AIR RS41

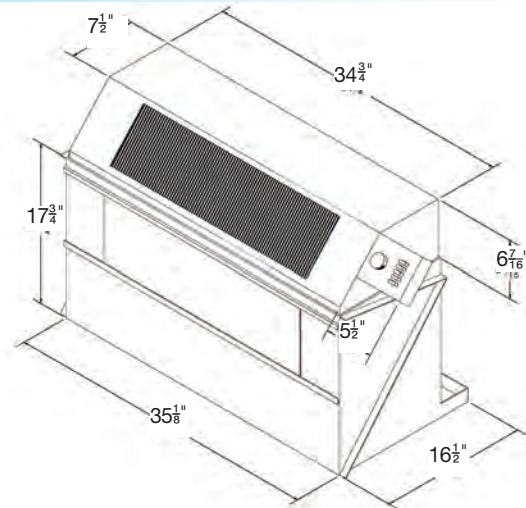

ICE AIR MODEL	MANUFACTURER	SERIES
RS41	AMERICAN AIR FILTER (AAF)	TYPE 25
	AMERICAN STANDARD	TYPE 41
	ISLANDAIRE	41
	RETROAIRE	RC15

## ICE AIR RSCM A/B/C

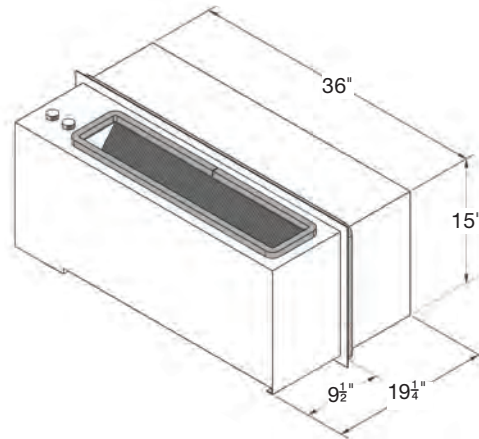

ICE AIR MODEL	MANUFACTURER	SERIES A	SERIES B* OR C*
<b>RSCM A/B/C</b>	CLIMATEMASTER	702,703,704	700 AD
	FRIEDRICH	702,703,704	700 AD
	WEIL-McCLAIN	702,703,704	700 AD
	ISLANDAIRE	CM	AD
	RETROAIRE	RC/RH20	RC/RH20

\*Control box configuration must be specified

## ICE AIR RSCT

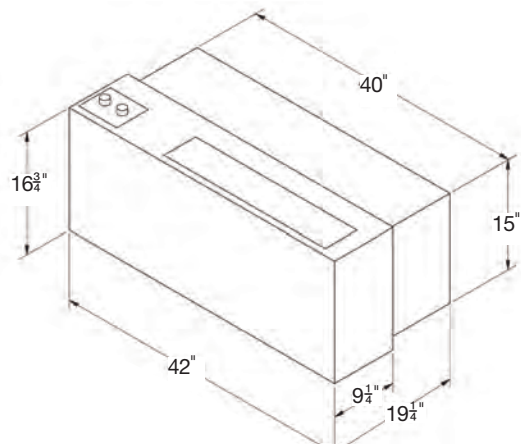

ICE AIR MODEL	MANUFACTURER	SERIES
<b>RSCT</b>	ICE-CAP	RSCT
	ISLANDAIRE	RT



## ICE AIR RSCT-JK

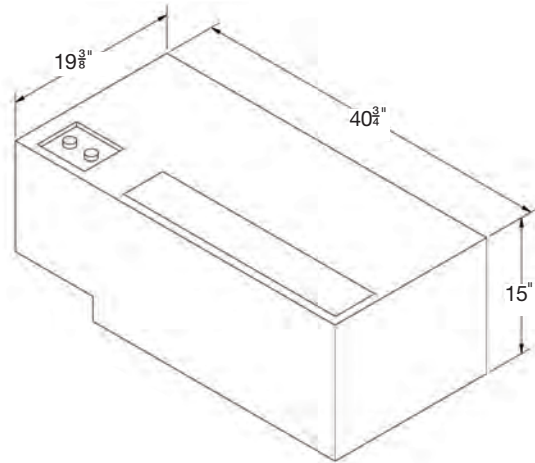

ICE AIR MODEL	MANUFACTURER	SERIES
RSCT-JK	SLANT FIN	JK
	ISLANDAIRE	JK

## ICE AIR RSCT-ZS

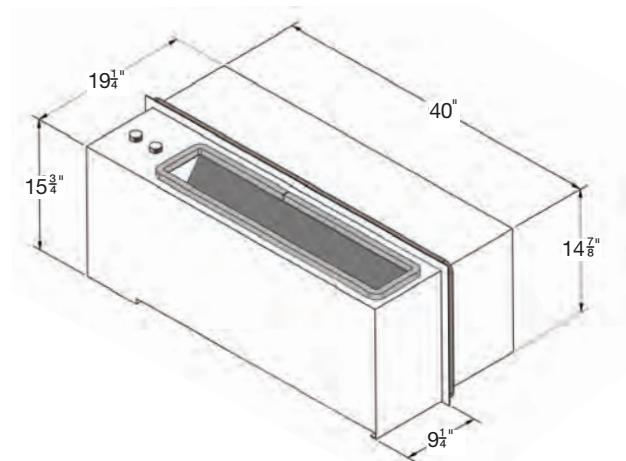

ICE AIR MODEL	MANUFACTURER	SERIES
RSCT-ZS	ICE-CAP	RSCT-ZS

## ICE AIR RSEA

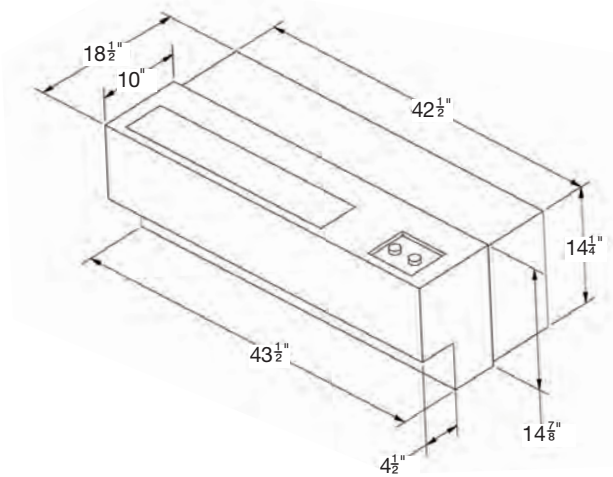
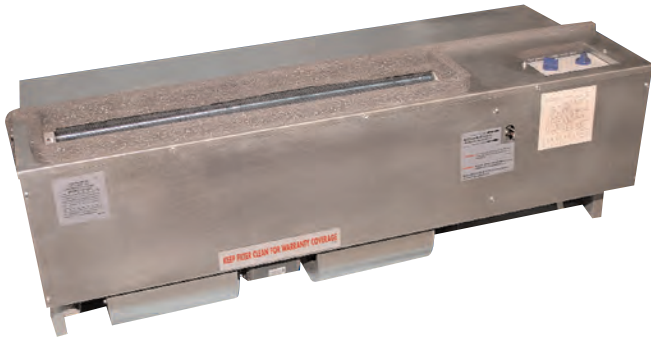

ICE AIR MODEL	MANUFACTURER	SERIES
<b>RSEA</b>	McQUAY	EA, ES, RS
	REMINGTON	EA, ES, RS
	SINGER	EA, ES, RS
	ISLANDAIRE	ED
	RETROAIRE	RC/RH35

## ICE AIR RSF

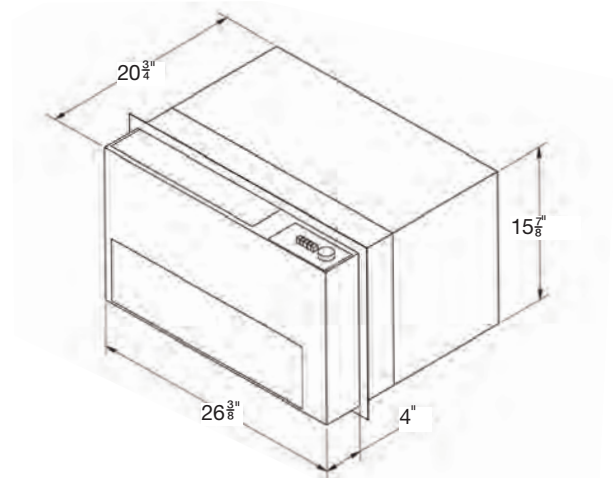

ICE AIR MODEL	MANUFACTURER	SERIES
<b>RSF</b>	FEDDERS	MAXIZONE
	ISLANDAIRE	MX
	RETROAIRE	RC40

## ICE AIR RSIW

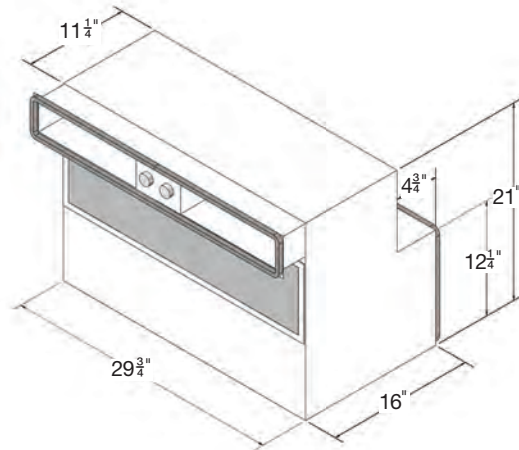

ICE AIR MODEL	MANUFACTURER	SERIES
RSIW	IW, WENIG	IW, "STEP-UP"

## ICE AIR RSK

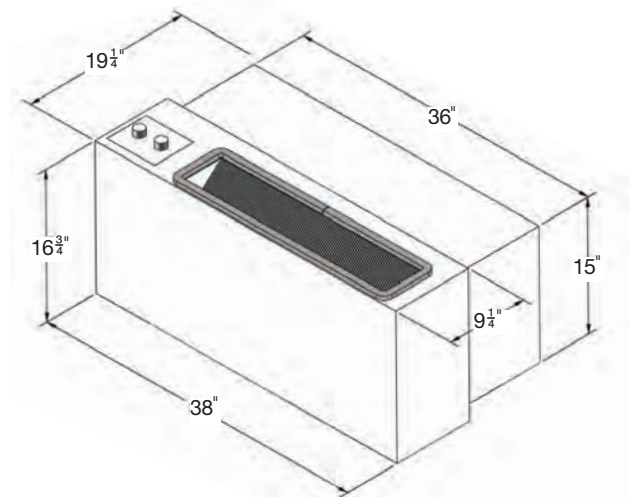

ICE AIR MODEL	MANUFACTURER	SERIES
RSK	ICE-CAP	RSK
	ISLANDAIRE	RK
	RETROAIRE	RC / RH22

## ICE AIR RSK/K

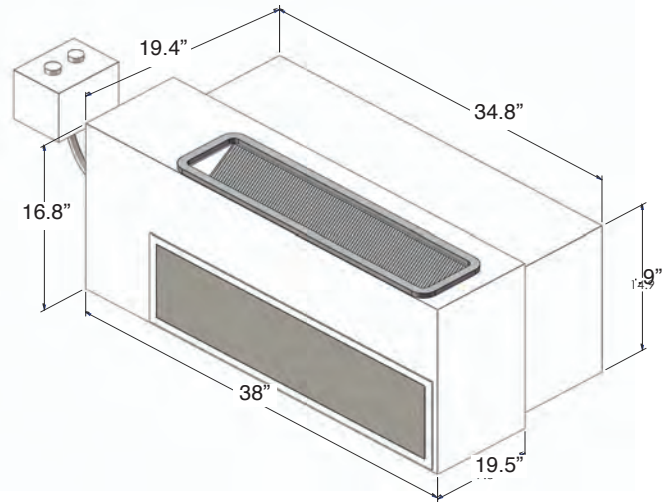

ICE AIR MODEL	MANUFACTURER	SERIES
RSK/K	SINGER	K, EK
	REMINGTON	K, EK
	McQUAY	K, EK, RK
	ICE-CAP	RSK/K, RSMK
	ISLANDAIRE	KF
	RETROAIRE	RC/RH60

## ICE AIR RSMK

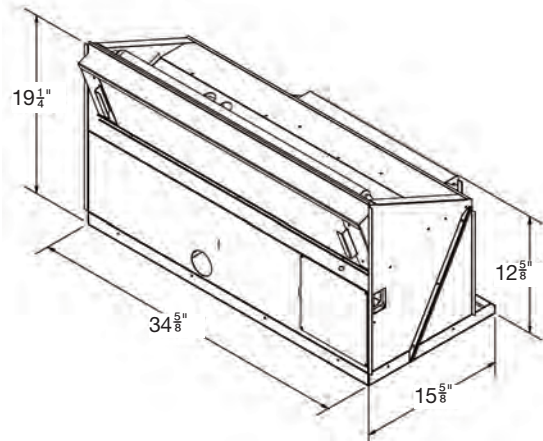

ICE AIR MODEL	MANUFACTURER	SERIES
RSMK	SINGER	K, EK
	REMINGTON	K, EK
	McQUAY	K, EK, RK
	ICE-CAP	RSK/K, RSMK
	ISLANDAIRE	KF
	RETROAIRE	RC/RH60

## ICE AIR RSNH

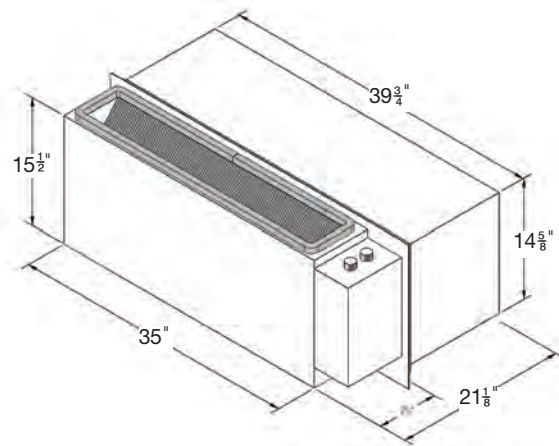

ICE AIR MODEL	MANUFACTURER	SERIES
RSNH	McQUAY	N, NH, PDNS
	SINGER	N, NH
	ISLANDAIRE	NE

## ICE AIR RSZ

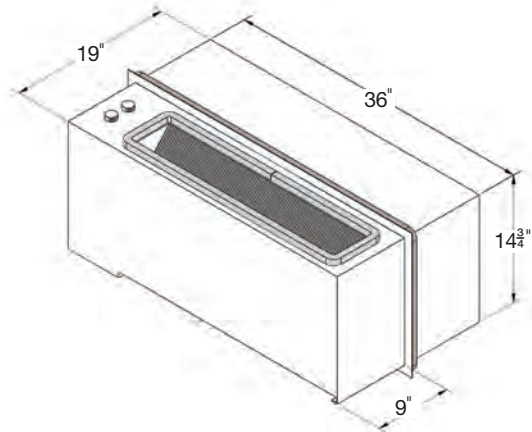

ICE AIR MODEL	MANUFACTURER	SERIES
RSZ	COOL HEAT	RM
	EMBASSY	WEATHER TWIN
	TPI	RaMATIC
	ZONEAIRE	RM, SC
	ISLANDAIRE	RM
	RETROAIRE	RC / RH20

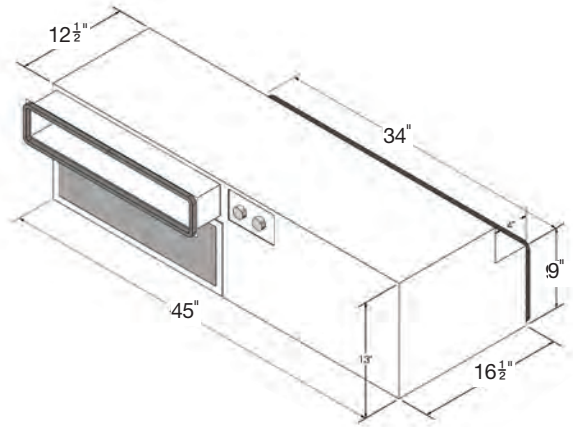

ICE AIR MODEL	MANUFACTURER	SERIES
WL	IW, WENIG	WL "COFFIN"
	ISLANDAIRE	WL



**We can provide customized HVAC solutions to meet specialized building project requirements, including:**

- Custom room enclosures
- Custom depth/configuration wall sleeves
- Multiple heat options (Electric, Hydronic, Heat Pump)
- Pre-piped hydronic packages
- Custom louvers and grilles
- Custom duct kits

**Contact ICE AIR directly for more information about Made2Measure.**



*BEFORE*



*AFTER*

# ACCESSORIES

## ICE AIR ExactFit™ Replacement PTAC Accessories:

ICE AIR's PTACs have different accessories to customize the unit for site or application requirements, including digital thermostats (for exact temperature control and maximum comfort), convenient motorized valves, outside fresh air dampers and a whole array of other accessories. Contact ICE AIR or your local ICE AIR representative for details.

**Replacements include: RS16, RS41, RSCM, RSCT, RSCT-JK, RSCT-ZS, RSEA, RSF, RSIW, RSK, RSK/K, RSMK, RSNH, RSZ, WL**

<b>VALVE PACKAGE COMPONENTS</b>	2-way Motorized Valve (NO/NC) – control valve (specify normally open or closed)
	3-way Motorized Valve (NO/NC) – control valve (specify normally open or closed)
	Ball/Shut-off Valves (2 per unit) – “Ball and Stem” shut-off valves
	Autoflow Balancing Valve – GPM must be specified
	Stainless Steel Braided Hoses
	Custom Valve Packages Available
	For additional piping options, please call ICE AIR directly.
<b>ELECTRIC HEAT OPTIONS</b>	1.5KW PTC Heating Element - 115 Volt (E2)
	3.0KW PTC Heating Element - 208 Volt (E3)
	3.5KW PTC Heating Element - 208, 277 Volt (E4)
	4.3KW PTC Heating Element - 208 Volt (E5)
	For additional electric heating options, please call ICE AIR directly.
<b>OUTSIDE AIR DAMPER</b>	Manual Outside Air Damper
	Motorized Outside Air Damper – to be controlled w/ rocker switch
	Extra Outside Air Damper – Increase standard OA flow up to 110 CFM
<b>ADVANCED FEATURES</b>	Xstream Air – Induced, filtered fresh air operating full-time (p. 18)
	ThermalGuard – Thermalbreak wall sleeve (p. 17)
	SoundShield – OITC sound transfer reduction (p. 17)
	AccuZone – Thermostat control options (p. 16)
<b>MISCELLANEOUS</b>	Dual Line Cords – Operates indoor fan for emergency heat
	Fan Cycle Switch (toggle switch) – Evaporator fan will shut off w/ compressor in A/C mode
	Security Key for Room Enclosure – Room enclosure with security key access
	Disconnect Switch – Power disconnect switch added to chassis
	Front Intake Chassis Modification – Conversion from bottom air return to front air return
	Detached Control Box – Control box on conduit separated from chassis
	Louvers – Extruded aluminum architectural outdoor louvers
	Hydronic Coils – Hot water or steam
	Room Enclosures – painted Antique White or Arctic White
	AirSpan – Lateral Air Duct Kit
	For additional customized solutions, please call ICE AIR directly.

# ACCUZONE ADVANCED CONTROLS



ICE AIR's controls are designed for ease-of-use and efficiency. Unit-mounted controls are standard (accessed through an attractive brushed aluminum control door). Optional wall-mounted remote controls are available for all of our PTACs.

## Digital Control Features:

- Quick-connection wiring for easy installation and maintenance
- Selectable Fahrenheit/Celsius read-out with accuracy of +/-1°F
- Temperature set-point range is 51°-91°F (10.6°-32.7°C)
- Large, clear backlit display that is easy to read in various lighting conditions



## MANUAL CONTROLS

- Four-position mode switch (Off – Heat – Hi Cool – Low Cool)
- Unit-mounted rotary control thermostat
- Standard low temperature control activates motorized heating control valve below 45°F
- Dual freeze-stats to prevent compressor and heating coil damage
- Six-position mode switch available for RSCT and RSK



## STANDARD DIGITAL TOUCHPAD

- User-friendly touchpad and read-out
- Precise temperature control
- Multiple fan speed options
- LCD display
- LEED compliant Night Setback feature



## 7 DAY PROGRAMMABLE

- 5/2 or 7-day programs for highest efficiency
- Factory or field-set temperature limits
- Large clear display – in any lighting condition
- Auto Changeover Mode
- Easy to program



## WIRELESS THERMOSTAT

- Easy programming
- Settings for morning, day, evening and night
- Clear backlit display readable in any lighting condition
- Auto changeover mode
- Optional remote temperature sensor available

For additional control options, including Building Management Systems and automated controls, please consult ICE AIR directly.



## ADVANCED FEATURES



A patented cost-effective make-up air solution, Xstream Air™ is an add-on Outside Air Module that provides from 20-120 CFM of filtered, tempered outside air through our advanced terminal equipment.

Xstream Air introduces a specified amount of outside air into the conditioned space, eliminating the need for separate make-up air systems or window-mounted “trickle vents.”

### Features:

- Upfront cost savings
- Meets outside air code requirements for fresh air intake
- Cost-effective add-on module for PTACs, WSHPs and FCUs



A patented technology that eliminates heat transfer from a building's exterior through the wall sleeve casing.

Typical sheet metal PTAC and thru-wall sleeves allow thermal transfer from outside elements to the building interior. With ThermalGuard technology greatly reducing thermal transfer, your PTACs and thru-wall units are more efficient and make a stronger contribution to overall building efficiency.

### Features:

- Heavy duty, galvanized steel construction
- Custom depths available to match any wall depth or configuration
- Available for all exterior walls, including masonry, precast, panel walls, EIFS and other built-up walls



An advanced PTAC sound technology that greatly improves sound transmission ratings for an entire wall system. SoundShield reduces outside sound noise transfer to the building's interior, lessening the effect of street, traffic, airport or train noise, and allowing buildings to meet minimum window/wall noise attenuation ratings.

### Features:

- Certified STC/OITC ratings
- Effective for certified NYC Noise E-Designation Remedial Action Plan

## OTHER PRODUCT LINES

ICE AIR manufactures full lines of Packaged Terminal Air Conditioners, Water Source Heat Pumps and Fan Coil Units for New Construction and Replacement/Retrofit applications.

### **WATER SOURCE HEAT PUMPS**

WSHPs are cooling and heating units that function independently and are piped to a central water loop for increased efficiency.

- Console (HPW)
- Vertical Stack (VHPW)
- Horizontal (HHPW)
- Vertical Closet (VCHPW)



VHPW



VERTICAL EXPOSED (FCVE)

### **FAN COIL UNITS**

FCUs are cooling and heating units that provide superior whisper quiet, energy efficient performance. They are guaranteed to lower installation and operating costs and are available in a variety of coil configurations.

- Horizontal Concealed (FCHC)
- Horizontal Concealed Ultra Thin (FCHU)
- Vertical Concealed (FCVC)
- Vertical Exposed (FCVE)
- Hi-Rise Stack (FCHR)

### **HYBRID WATER-COOLED AIR CONDITIONER**

The Hybrid Water-Cooled Air Conditioner (WCAC) combines high-efficiency cooling with an advanced hot water coil to provide hydronic heat for an entire room without using the unit's compressor.

The high capacity heating coil operates at low Entering Water Temperatures (EWT), between 105°-125°F. These units, when coupled with a high efficiency condensing boiler, provide the most cost-effective and efficient method of space heating for multi-family buildings, lodging, dormitories and similar properties.

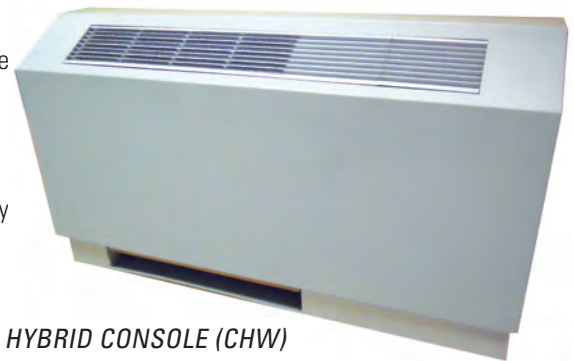

*HYBRID CONSOLE (CHW)*

#### **Features:**

- Uses a fraction of the energy required for heating and cooling compared to traditional WSHPs and other HVAC systems
- Available in Console, Horizontal, Vertical "Closet" and Vertical Stack configurations
- Low EWT allows for condensing boiler use
- High environmental efficiency – one of the greenest systems available

### **SINGLE PACKAGE VERTICAL AIR CONDITIONER/HEAT PUMP**

The Single Package Vertical Air Conditioner and Heat Pump (SPAC/HP) is a unique air-to-air unit that provides ultra-quiet operation and high energy efficiency cooling and heating. The SPAC is available with Standard and High Velocity condenser configurations which are designed to cool and heat multiple spaces within multi-family, lodging, dormitory and light commercial buildings. Both versions feature easy maintenance and low installation costs and eliminate the need for space-consuming outdoor condenser equipment.



*SPAC/HP*

#### **Standard SPAC Features:**

- Chassis installs into wall plenum with an architectural exterior louver
- Compact, self-contained design allows for additional space in equipment rooms
- Dual motor design – quiet indoor airflow and variable condenser CFM allow for easy customization

#### **High Velocity SPAC Features:**

- Works from within an interior wall space for zoned climate control in multiple rooms
- Versatile condenser air ducting options allow a designer more control over exterior louver placement
- Designed to overcome high static pressure of up to .75"



# ICE AIR®

World Class Comfort®

80 Hartford Avenue, Mount Vernon, NY 10553 | Tel: 877-ICE-AIR-1 (877-423-2471) | Fax: 914-668-5643

[www.ice-air.com](http://www.ice-air.com)

